

Location Plan

Browns Lane/ Access to Bloor Homes development Proposed Road Hump (Raised Junction)

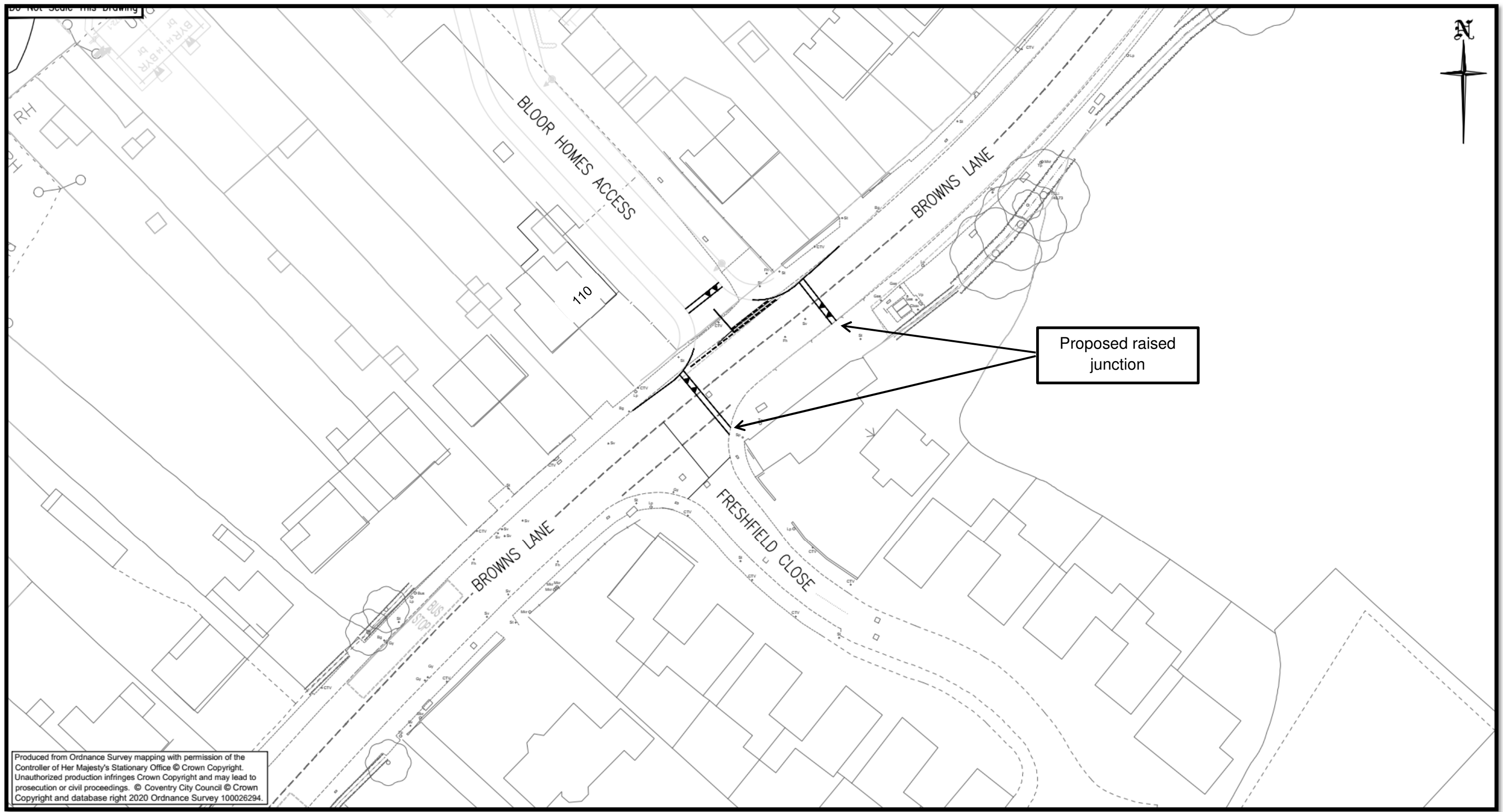

Produced from Ordnance Survey mapping with permission of the Controller of Her Majesty's Stationary Office © Crown Copyright. Unauthorized production infringes Crown Copyright and may lead to prosecution or civil proceedings. © Coventry City Council © Crown Copyright and database right 2020 Ordnance Survey 100026294.