

Do Not Scale This Drawing

DO NOT SCALE FROM THIS DRAWING
ALL DIMENSIONS TO BE CHECKED
PRIOR TO CONSTRUCTION

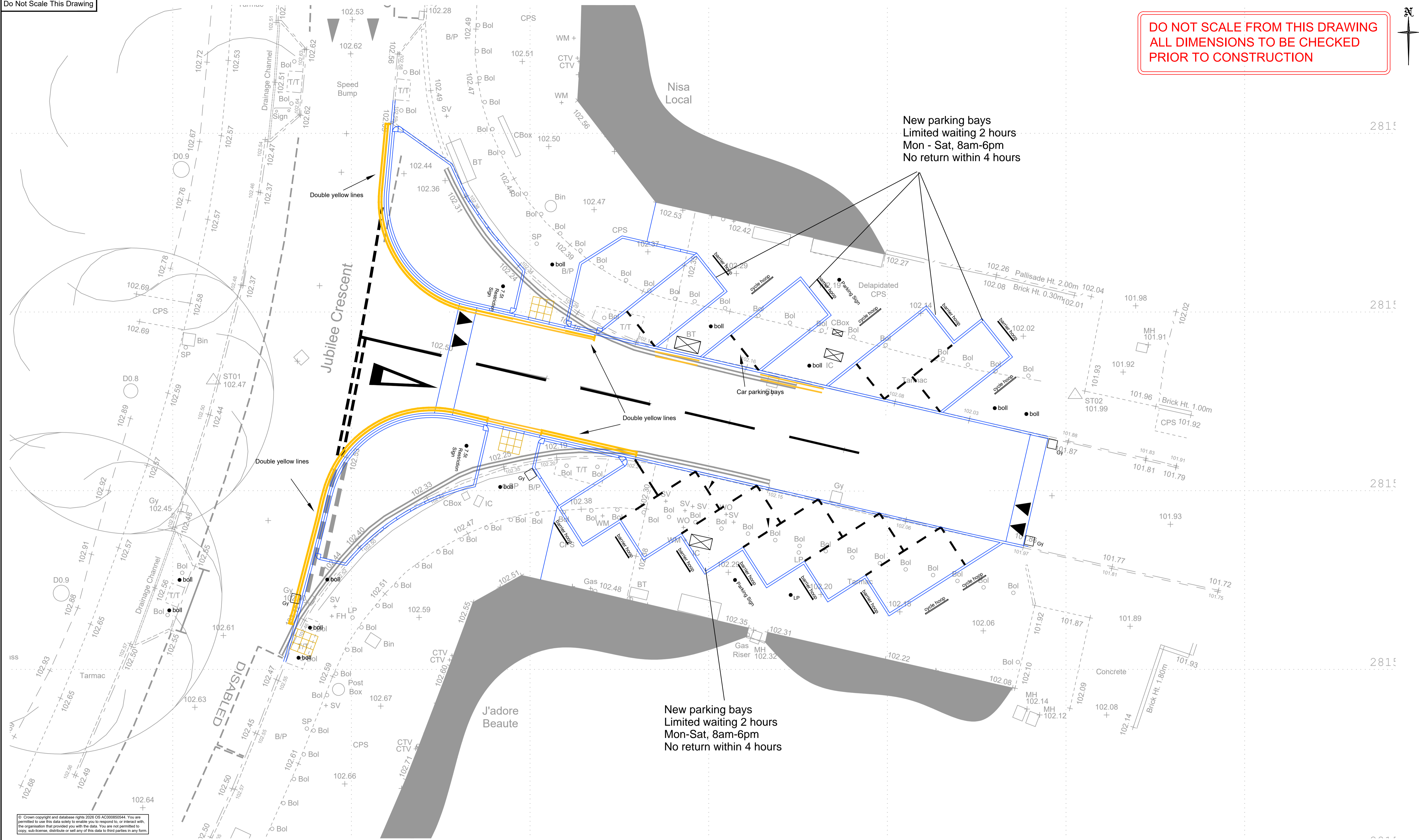

P:\CDD\CRSTS\Foleshill\Jubilee Crescent\1200 Road Marking sub.dwg - 29/01/2026 12:03:54 - 01 - cypau172

Old extents of double yellow lines shown as double grey lines.
New extents of double yellow lines shown in yellow.

Road Marking Notes

- All dimensions are in metres unless noted otherwise. all dimensions to be checked prior to construction. do not scale from this drawing.
- All works to be constructed in accordance with coventry city council highways specification.
- Any discrepancies found in this drawing are to be reported immediately to the engineer for clarification and advice.
- This drawing is to be read in conjunction with all relevant design drawings, engineering details and the specification.
- All levels and dimensions shall be verified onsite prior to the commencement of any work any discrepancies shall immediately be brought to the attention of the project manager.

SAFETY, HEALTH AND ENVIRONMENTAL INFORMATION

IN ADDITION TO THE HAZARDS/RISKS NORMALLY ASSOCIATED WITH THE TYPES OF WORK SHOWN ON THIS DRAWING, NOTE THE FOLLOWING SIGNIFICANT RESIDUAL RISKS:

CONSTRUCTION

- SERVICES - RISK OF STRIKING SERVICES
- UNEXPLODED ORDNANCE - RISK OF DISTURBING UNEXPLODED ORDNANCE
- NARROW WORKING AREAS IN LIVE TRAFFIC - RISK OF WORKERS BEING STRUCK BY VEHICLES
- HIGH VOLUME OF PEDESTRIANS - RISK OF PEDESTRIANS ENTERING SITE
- WORKING WITH HOT MATERIALS
- CELLARS - SUDDEN EXCAVATION COLLAPSE
- DEEP EXCAVATIONS FOR DRAINAGE CONNECTIONS
- DRAINAGE CONNECTIONS TO COMBINED SEWERS

RISK IDENTIFIED

NONE IDENTIFIED

MAINTENANCE/CLEANING

- SERVICES - RISK OF STRIKING SERVICES
- HIGH VOLUME OF PEDESTRIANS - RISK OF PEDESTRIANS ENTERING SITE
- CELLARS - SUDDEN EXCAVATION COLLAPSE

DECOMMISSIONING/DEMOLITION

- SERVICES - RISK OF STRIKING SERVICES
- UNEXPLODED ORDNANCE - RISK OF DISTURBING UNEXPLODED ORDNANCE
- CELLARS - SUDDEN EXCAVATION COLLAPSE
- HIGH VOLUME OF PEDESTRIANS - RISK OF PEDESTRIANS ENTERING SITE

IT IS ASSUMED THAT ALL WORKS WILL BE CARRIED OUT BY A COMPETENT CONTRACTOR (WORKING, WHERE APPROPRIATE, TO AN APPROVED METHOD STATEMENT).

- PRESENCE OF BURIED STATUTORY UNDERTAKERS PLANT
- WORKING IN CLOSE PROXIMITY TO LIVE TRAFFIC
- TRAFFIC MANAGEMENT ON APPROACH TO SITE
- DRAINAGE RECORD NOT AVAILABLE FROM COVENTRY CITY COUNCIL
- CONTRACTOR TO IDENTIFY EXISTING GULLY OUTFALL INFORMATION PRIOR COMMENCEMENT OF THE DRAINAGE WORKS

CONTRACTOR IS RESPONSIBLE FOR MOVING AND REPOSITIONING DETECTOR LOOPS

ASSET INFORMATION IS NOT AVAILABLE FROM COVENTRY CITY COUNCIL TO CONFIRM WHETHER OR NOT THERE IS RISK OF ASBESTOS IN THE GROUND OF HIGHWAY ASSETS. THE CONTRACTOR SHALL ASSESS FOR RISK FOR ASBESTOS PRIOR TO CARRYING OUT WORKS. HIGH RISK ACTIVITIES WOULD BE ALTERATIONS TO EXISTING DRAINAGE ASSETS OR ALTERATIONS.

Project Title:
**Coventry City Council
Traffic Management
Owenford Road**

Drawing Title:
Proposed Waiting Restrictions

Scale at A1:
NTS

Status:
Waiting restrictions

Drawn:
DON
06-03-26

Checked:

Approved:

Drawing Number:
DON-OWE-1200-01

Rev
0

ECONOMIC GROWTH, TRAFFIC MANAGEMENT, FLOOR 8, ONE FRIARGATE, COVENTRY, CV1 2GN
TEL: 024 7683 4333 FAX: 024 7683 1324

