

12

COVENTRY CITY COUNCIL

ENVIRONMENTAL PROTECTION ACT 1990, SECTIONS 8(8), 12

NOTICE OF REVOCATION

To: **Mr Newcombe
Kingsley Garage
1-3 Arbury Avenue
Coventry
CV6 6FD**

Coventry City Council ("the Council"), in exercise of the powers conferred on it by section 8(8), 12 of the Environmental Protection Act ("the Act"), hereby gives you notice as follows:

(for section 12(1) notices)

1. The authorisation reference **012** is hereby revoked with effect from **25/05/2001**.

Signed on behalf of Coventry City Council



.....
City, Environment Officer
The officer appointed for that purpose

1st May 2001

Date:

51

CERTIFICATE OF SERVICE BY HAND
I, being employed
as a in the Housing and
Environmental Services Directorate of
Coventry City Council hereby certify that the
Notice of which this is a copy was
served/delivered by me to
of County
on 19.....
Signed

**INFORMATION
ONLY**

THE ENVIRONMENTAL PROTECTION ACT 1990

The Environmental Protection (Prescribed Processes and Substances) Regulations 1991 (as amended),

The Environmental Protection (Application, Appeals and Registers) Regulations 1991 (as amended),

**Authorisation No: 012
Application Received: 28th October 1991**

Notice is hereby given that under Section 6 of the Environmental Protection Act 1990, Coventry City Council (hereinafter called the Authority) gives authorisation to:

**Kingsley Garage Services
1/3 Arbury Avenue
Foleshill
COVENTRY
CV6 6FD**

to operate a waste oil burner of 0.033Mw net rated thermal input manufactured by Kongskilde and identified as Thermobile AT400 (hereinafter: the appliance) at:

***Kingsley Garage Services
1/3 Arbury Avenue
Foleshill
COVENTRY
CV6 6FD**

subject to the conditions on pages 2-3 of this authorisation and within the process boundary as indicated on Plan No. 1.

Signed Dated day of 199.....
City Environment Officer

1. DESCRIPTION OF PROCESS

- 1.1 Only hydrocarbon-based oils arising from the draining of engines, gearboxes and other lubrication systems at the address marked * on page 1 of this authorisation shall be burned in the appliance. No waste oil from other sources shall be burned in the appliance.

The following shall at no time be burned in the appliance:

- i. any halogenated materials;
 - ii. polycyclic or polyaromatic compounds arising other than by use as a lubricating oil;
 - iii. low-flash-point fuels, oils or solvents (less than 40°C determined by the Pensky-Marten closed cup method);
 - iv. surface-coating materials eg. paint.
- 1.2 Where any modification to the appliance is intended, with the exception of the fitting of standard replacement parts, details of the modification shall be notified to the Authority and approval obtained prior to the modification being undertaken.

2. PROCESS CONTROLS

- 2.1 The appliance shall be refuelled only when cold.
- 2.2 All staff who are nominated to operate the appliance shall be trained in, and fully conversant with, its operation in accordance with the manufacturer's instructions for that appliance. Special attention shall be given to the correct procedure for lighting the appliance from cold. Only nominated persons shall operate the appliance.
- 2.3 Clear instructions shall be prominently displayed at all times on or near the appliance, detailing its correct operation and maintenance.
- 2.4 The appliance shall be cleaned and ash shall be removed in accordance with the manufacturer's instructions for that appliance.
- 2.5 The appliance, including the fuel feed system and chimney, shall be thoroughly inspected once a week during operational months to ensure that there are no defects which could lead to excessive smoke emission. The weekly examination shall include an assessment of the smoke emission from the appliance during lighting from cold and in normal operation. The results of the inspection shall be noted in a log book, together with the date and the identity of the person undertaking the inspection.
- 2.6 The appliance shall be serviced regularly in accordance with the manufacturer's instructions for that appliance. Suitable precautions shall be taken in the handling and disposal of ash, dust or other residues to minimise any emission to atmosphere. The material shall be collected, contained and transported in sealed bags or other dust-tight containers.
- 2.7 Where smoke emissions occur, with the exception of the allowance for lighting from cold in Condition 4.1 below, the appliance shall be switched off and the cause identified and rectified before the appliance is relit.

2.8 Waste oil shall be stored and handled so as to minimise the emission of odorous vapours to the air. It shall be stored in closed containers in the bunded area marked 'A' on Plan 1. Suitable covered containers shall be used to transfer it to the appliance.

2.9 A supply of a suitable oil-absorbent material shall be maintained on site, and any liquid spillage shall be cleaned up immediately.

3. CHIMNEY

3.1 The appliance shall be permanently ducted to a chimney, marked 'B' on Plan 1, which shall be 6 metres above ground level.

3.2 The chimney shall discharge vertically upwards, and shall be free from any cap, plate, or other restricting device which would interfere with the upward flow of flue gases.

4. EMISSION LIMITS AND CONTROLS

4.1 All emissions to air shall be free from visible smoke and in any event shall not exceed the equivalent of Ringlemann Shade 1 as described in British Standard 2742 : 1969. In the case of lighting from cold, emissions of smoke exceeding Ringlemann Shade 1 are permitted for not more than 10 minutes.

5. EMISSION MONITORING

5.1 Where the operator observes smoke emissions which contravene the requirements of Condition 4.1 above, the operator shall record the date and time that the emission occurred in the log book specified in Condition 2.5 above. Records of such emissions shall be retained for a minimum of four years.

This is not part of the Authorisation

SUPPLEMENTARY NOTES

1. Your attention is drawn to your obligation under Section 7(2)(a) of the Environmental Protection Act 1990 to ensure that in the carrying out of the prescribed process the best available techniques not entailing excessive cost (BATNEEC) will be used:
 - (i) For preventing the release of substances prescribed for any environmental medium into that medium or, where that is not practicable by such means, for reducing the release of such substances to a minimum and for rendering harmless any such substances which are so released.and
 - (ii) For rendering harmless any other substances which might cause harm if released into any environmental medium.
2. The Authority for contact purposes shall be taken to mean the Head of the Pollution Control Section, telephone 831832 during office hours, 832222 outside office hours.
3. This Authorisation allows you to burn your own arisings of waste oil as fuel. Stricter conditions apply if you wish to use additional waste oil from other sources. This is because of the greater risk that such additional oil may have been contaminated.
4. If you wish to modify either the appliance or the activities permitted by this Authorisation, you must apply to us and obtain written permission beforehand.

1-3 Arbury Ave. Mr Newcombe
Foleshill. tel 666195



City of
Coventry

ENVIRONMENTAL PROTECTION ACT 1990 section 10

NOTICE OF VARIATION OF AUTHORISATION

To **Kingsley Garage Services**

Of **1/3 Arbury Avenue, Foleshill, Coventry, CV6 6FD**

The **Coventry City Council**

(the Authority) has decided that the authorisation to carry out a prescribed process, namely:

To operate a Kongskilde waste oil burner of 0.033 Mw net rated thermal input - Model AT400

at the premises known as **Kingsley Garage Services**

granted to you by the Council on the **5th** day of **April 1993** under the reference number **012** should be varied in the following manner*

- 1) **Delete all existing conditions and replace with enclosed schedule pages 2, 3 and 4.**

(PLEASE SEE ATTACHED)

The date(s) on which the variation(s) are to take effect are†

- 1) **Immediate**

continued overleaf

Delete any words in square brackets which do not apply

* Specify the variation(s) to the authorisation.

† Specify the effective dates for each variation.

YOU ARE REQUIRED, within a period of 28 days from the date of service on you of this Notice, to notify the Authority of the action (if any) which you propose to take to ensure that the process is carried on in accordance with the authorisation as varied by this Notice.

~~[In the opinion of the Authority, the action to be taken by you in consequence of this Variation Notice will involve a substantial change** in the manner in which the process is being carried on.]~~

Dated 28 APR 1999

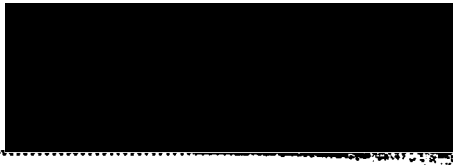
(Signed) 

(Designation) DIRECTOR
(the Officer appointed for this purpose)

Address for all communications:

Housing and Environmental S
Broadgate House
Broadgate
COVENTRY
CV1 1NH

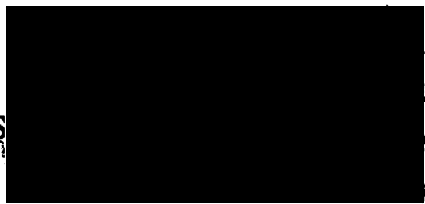

COVENTRY CITY COUNCIL
Notice of which this is a copy was served/delivered by me to Mr. Newcombe of Kingley Garage, Abbey Ave., Coventry on 28 April 1999
Signature: 
NOTE

Delete any words in square brackets which do not apply

You have a right of appeal against this Notice to the Planning Inspectorate. If you wish to appeal you must do so in writing within a period of two months beginning with the date of this Notice. You must set out the grounds for your appeal and send to the Planning Inspectorate a copy of this Notice, together with copies of all relevant documents and correspondence. You should also indicate whether you wish the appeal to be dealt with at a hearing or on the basis of written representations. A copy of your Notice of Appeal must also be sent to the Council.

** "Substantial change" is defined in Section 10(7) of the Environmental Protection Act 1990 as "a substantial change in the substances released from the process or in the amount or any other characteristic of any substance so released"; and the Secretary of State may give directions to enforcing authorities as to what does or does not constitute a substantial change in relation to processes generally, any description of process or any particular process.

Reference : IC/IP/SB
Reference : S Bodycote
Use ask for : 831882
Direct Dialling No: 2 April 1993



ENVIRONMENTAL SERVICES DEPARTMENT

Howard T. Farrand,
Director of Environmental Services,
Broadgate House,
Broadgate,
Coventry, CV1 1NH

Telephone : 0203 83 33 33
Telex : 265451 (MONREF G)
Attention ENDO42
Telecom Gold Mailbox: 76 : ENDO42
Fax : 0203 831831

Mr Newcombe
Kingsley Garage Services
1/3 Arbury Avenue
Foleshill
COVENTRY
CV6 6FD

Dear Mr Newcombe

Environmental Protection Act 1990
Authorisation of Waste Oil Burner Under 0.4mw

Please find attached your authorisation for a waste oil burner facility at Kingsley Garage Services, Arbury Avenue.

Please note that failure to comply with any of the conditions contained in the authorisation is an offence and is punishable on summary conviction by a fine of up to £20000.

The possession of an authorised waste oil burner is subject to an annual subsistence fee of £100 payable on 1st April each year. For part years the fee is payable on a pro rata basis.

Please note that condition 6.2 requires certain works to be done to the chimney by the latest 1st April 1994. Should you wish to discuss the contents of the authorisation further at this time, please do not hesitate to contact me.

Yours sincerely,

[Redacted Signature]
S Bodycote
Scientific Officer

epa_B_auth/king.lett

Protecting Our City

Our Reference :
Our Reference : CI/IP/SS
Please ask for : S Bodycote
Direct Dialling No: 831882
Date : 5th April 1993



ENVIRONMENTAL SERVICES DEPARTMENT

Howard T. Farrand,
Director of Environmental Services,
Broadgate House,
Broadgate,
Coventry, CV1 1NH

Telephone : 0203 83 33 33
Telex : 265451 (MONREF G)
Attention END042
Telecom Gold Mailbox: 76 : END042
Fax : 0203 831831

THE ENVIRONMENTAL PROTECTION ACT 1990

**The Environmental Protection (Prescribed Processes and Substances)
Regulations 1991, (As Amended)**

**The Environmental Protection (Application, Appeals and Registers)
Regulations 1991, (As Amended)**

Authorisation No: 012
Application Received: 28.10.91

Notice is hereby given that under Section 6 of the Environmental
Protection Act 1990, Coventry City Council (hereafter called the
Authority) gives authorisation to:

**Kingsley Garage Services
1/3 Arbury Avenue
Foleshill
Coventry
CV6 6FD**

To operate a waste oil burner of 0.033Mw net rated thermal input
manufactured by Kongskilde and identified as Thermobile AT400 at:

**Kingsley Garage Services
1/3 Arbury Avenue
Foleshill
Coventry
CV6 6FD**

Subject to the conditions on pages 1-3 and within the process
boundary as indicated on Plan No. 1.

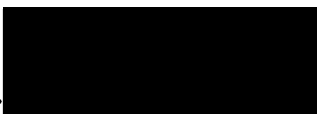
signed  ..
Assistant Director of
Environmental Services

Dated 5th day of April 1993

1. PROCESS DESCRIPTION

1.1 This authorisation is for the operation of a Kongskilde waste oil burner model AT400 within the process boundary outlined in red on the attached plan No. 1 for combustion of hydrocarbon based waste oils arising from operations on the site as prescribed under Section 1.2 Part B(e) of The Prescribed Processes and Substances Regulations 1991.

2. PERMITTED FUELS

2.1 Only hydrocarbon based oils arising from the drainage of engines, gearboxes and other lubrication systems at the premises whose address is given on page 1 shall be burned on the appliance.

2.2 The following shall not be burned on the appliance at any time:

- i. any halogenated materials;
- ii. polycyclic or polyaromatic compounds arising other than by use as a lubricating oil;
- iii. low temperature flash point fuels, oils or solvents (less than 40°C determined by the Pensty-Marten closed cup method);
- iv. surface coating materials eg. paint.

2.3 Waste oils other than produced on the site shall not be burned or brought onto the site for the purpose of combustion.

3. EMISSION LIMITS AND CONTROLS

3.1 All emissions to air shall be free from visible smoke and in any event shall not exceed the equivalent of Ringleman Shade 1 as described in British Standard BS 2742 : 1969 except in the case of lighting from cold, when emissions of smoke shall not exceed Ringleman Shade 1 for more than 10 minutes.

3.2 There shall be no offensive odour from the operation of the unit outside the boundary of the premises as perceived by the Local Authority Inspector.

4. EMISSION MONITORING

4.1 Where the operator observes smoke emissions which contravene the requirements of Condition 3.1 above, the operator shall record the date and time that the emission occurred in a log book. Records of such emissions shall be retained for a minimum of 4 years at the premises and shall be made available to the inspector on demand.

4.2 Should any emission of dark smoke occur in contravention of 3.1 the unit shall be switched off and shall not be relit until the cause of the emission has been identified and the problem rectified. The authority should be immediately contacted in the event of emissions in contravention of 3.1.

5. PROCESS CONTROLS

- 5.1 Where smoke emissions occur, with the exception of the allowance for lighting from cold in Condition 3.1 above, the appliance shall be switched off and the cause identified before the appliance is relit.
- 5.2 The appliance, including the fuel feed system and chimney, shall be thoroughly inspected once a week during operational months to ensure that there are no defects which could lead to excessive smoke emissions. The weekly examination shall include an assessment of the smoke emission from the appliance during lighting from cold and in normal operation.
- 5.3 Results of monitoring as in 5.2 shall be recorded in the log book as in 4.1 detailing the date, time, identity of person undertaking the inspection and observation result.
- 5.4 The appliance shall be cleaned and ash removed in line with the manufacturer's instructions as contained in the instructions and service manual, model AT400 waste oil heater. Ash dust or residues shall be removed carefully so as to minimise emission to atmosphere. Ash and residues shall be stored and transported in sealed bags or dust tight containers.
- 5.5 The appliance shall be serviced at least every 3 months in line with the manufacturer's instructions as referred to in 5.4.
- 5.6 Clear instructions as to proper use of the unit shall be prominently displayed at all times on or near the appliance detailing the correct operation, lighting and maintenance of the equipment.
- 5.7 Only persons having received instruction as to the proper lighting and operating procedure as contained in the Kongskilde instructions and service manual for the AT400 waste oil burner shall be allowed to operate the unit.
- 5.8 Sawdust or other suitable oil absorbent shall be kept on site for soaking up any spillage of waste oil. Any spillage of waste oil shall be cleaned up as soon as possible.

6. CHIMNEYS

- 6.1 The appliance shall not be operated unless connected to the 6m chimney.
- 6.2 By the 1st October 1994 the cap on top of the chimney shall have been removed. [It may be replaced by a non restrictive cowl as described in note 3 to prevent rain ingress]

This is not part of the Authorisation

SUPPLEMENTARY NOTES

1. Your attention is drawn to your obligation under section 7(2)(a) of the Environmental Protection Act 1990 to ensure that in carrying out of the prescribed process the best available techniques, not entailing excessive cost (BATNEEC) will be used:

(i) For preventing the release of substances prescribed for any environmental medium into that medium or, where that is not practicable by such means, for reducing the release of such substances to a minimum and for rendering harmless any such substances which are so released.

and

(ii) For rendering harmless any other substances which might cause harm if released into any environmental medium.

2. The Authority for contact purposes should be taken to mean the Head of the Pollution Control Section, telephone 831810 during office hours, 832222 outside office hours.

3. Kroll produce is a non-restrictive cowl for flue outlets based on a sleeve design. Other such devices have been produced by Kongskilde or may be individually constructed.

epa_B_auth/king

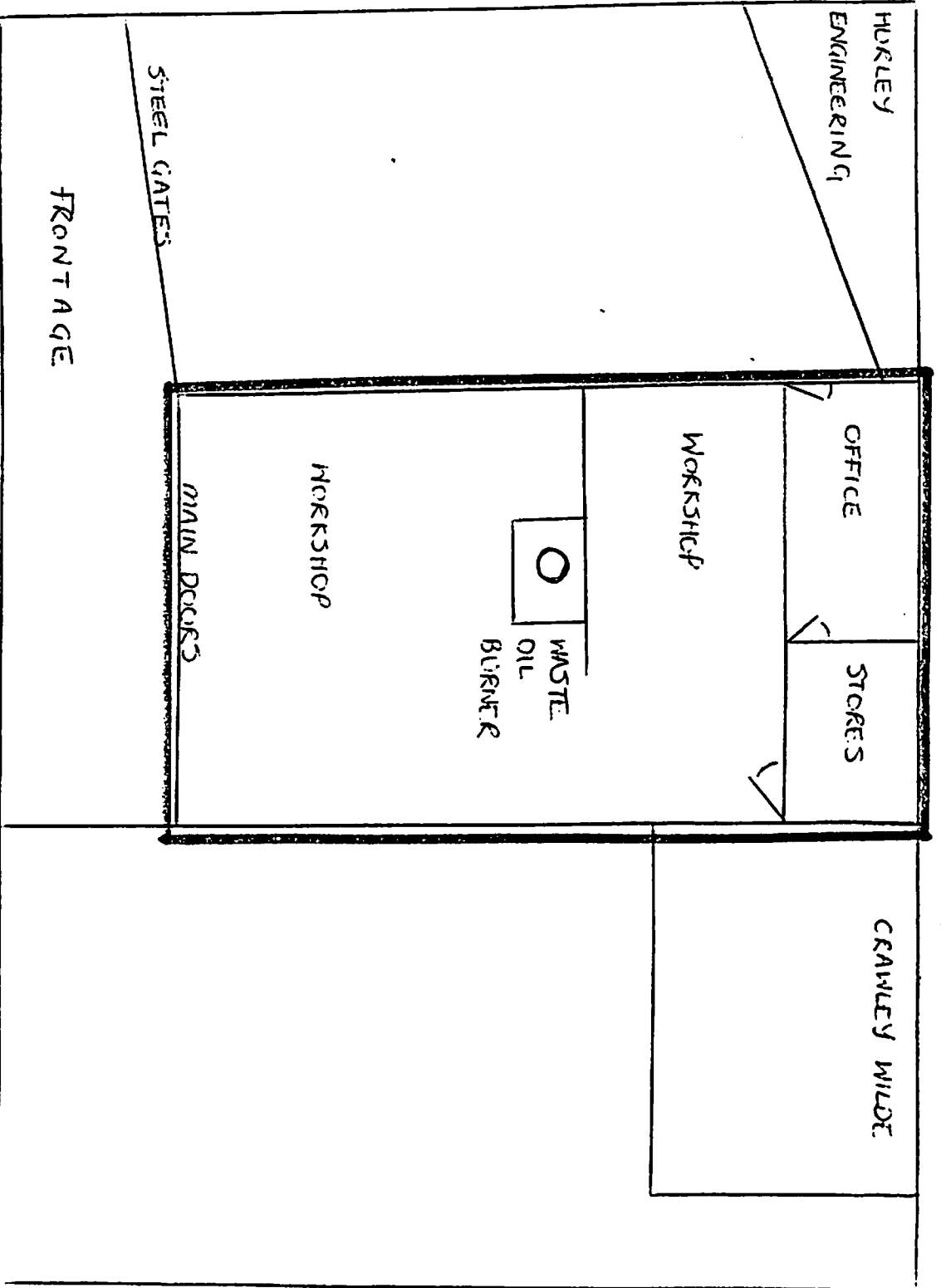

FOLESHILL ROAD

ARBURY AVENUE

APPLICATION FOR AUTHORISATION, UNDER SECTION 6 OF THE ENVIRONMENTAL PROTECTION ACT 1990, TO OPERATE A WASTE OIL BURNER WITH NET RATED THERMAL INPUT OF LESS THAN 0.4 MW, BURNING THE OPERATOR'S OWN ARISING OF WASTE OIL ONLY.

1. Either Name and address of applicant

..... Mr D. Newcombe
..... Mr R. ASHBY & Mr D. NEWCOMBE
.....
.....

OR Name, number and registered office of applicant company (if applicable)

..... KINSLEY GARAGE SERVICES
..... 1/3 ARBURY AVENUE
..... FOLKSHILL
..... COVENTRY CV6 6FD
.....

2. Name and address of premises where process is or will be carried on

..... AS ABOVE
.....
.....
.....

A plan showing the location of the premises where the appliance will be installed must be attached.

3. Make and model name/number of the appliance(s) to be installed

..... KONGSKILDE AT 400
.....

4. Is the appliance(s) constructed or adapted so as to comply with BS4256?

Yes/No

5. What is the net rated thermal input of the appliance(s)?

..... SEE SPECIFICATIONS
..... 112,000 BTU's /hr

6. What fuel will be burned on the appliance?

.....WASTE OIL.....
.....

7. What is the source of the fuel?

.....VEHICLES.....
.....

8. What is the height and location of the proposed chimney serving the appliance(s)?

.....6 METRES.....
.....

9. What is the efflux velocity, in normal operation, of the waste gases leaving the chimney to the appliance(s)?

.....NATURAL DRAUGHT.....

10. Where will the fuel storage tank vents be situated?

.....SEALED BARREL STORED OUTSIDE
SEE X ON PLAN.....

Fee enclosed (cheques made payable to the
District/Borough Council)

£ 100.....

I hereby certify that all the information contained in this application is, to the best of my knowledge, correct.

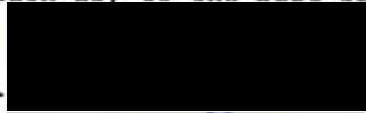

(Signature) 25/10/91 (Date)

BURNER SPECIFICATIONS from MANUAL.

- MAX OUTPUT 112,000 BTU/HR
- MIN OUTPUT 64,000 BTU/HR
- MAX FUEL CONSUMPTION 4.3 LITRES/HOUR
- MIN FUEL CONSUMPTION 2.5 LITRES/HOUR
- FUEL TANK CAPACITY 42 LITRES
- POWER CONSUMPTION 1 AMP
- VOLTAGE 220/240V 50HZ
- FLUE CONNECTION 150MM DIA
- HEIGHT 105 CM
- WIDTH 71 CM
- DEPTH 88 CM
- WEIGHT 130 KG.

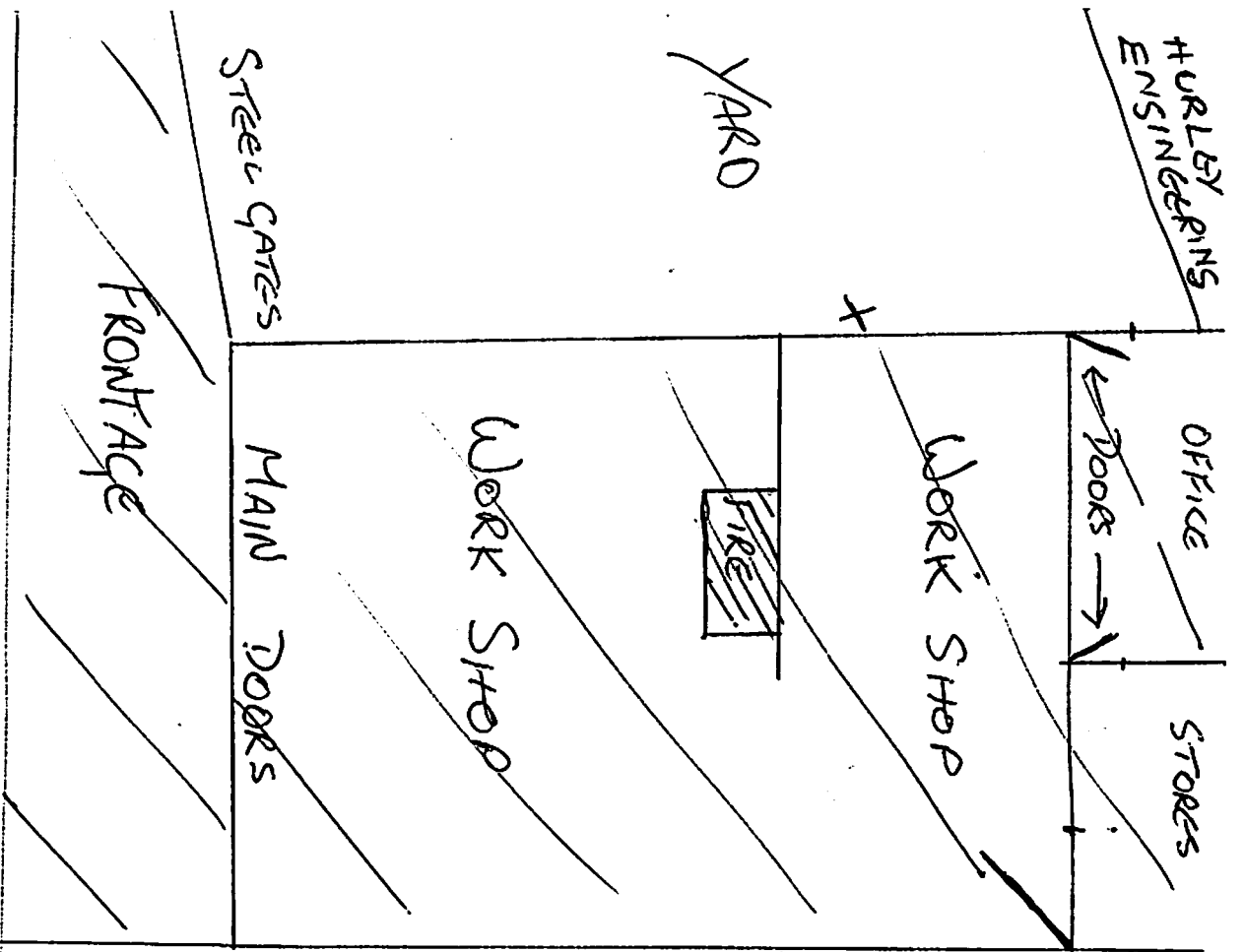

ARBURY Ave

CRAWLEY WIDE
ADJACENT PREMISES

LOCATION PLAN
OF KINGSLEY GARAGE
AND SITING OF OIL BURNER.

FOLWELL ROAD

ENVIRONMENTAL SERVICES DEPT.	
REF. TO	20 SEP 1971
ACK.	REPLY

Kingsley Services
1000 ISS